

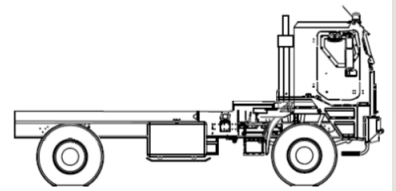

**vehicles for professionals**

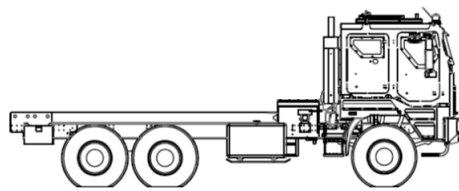

**HTV AX**  
HEAVY TRANSPORT VEHICLE

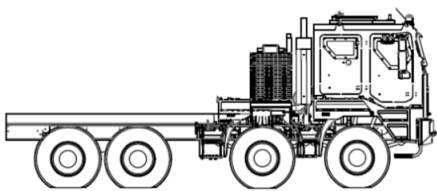

**BUILT BY PROFESSIONALS  
FOR PROFESSIONALS**

# STI STEYR

## Dimensions & Weight (AX 6x6) Single Tire

<b>Length</b>	9960 mm
<b>Width</b>	2550 mm
<b>Ground clearance</b>	410 mm
<b>Wheelbase</b>	<b>from</b> 4100+1450 mm <b>up to</b> 5100+1450 mm
<b>Gross Vehicle Weight</b>	36,500 kg

## Performance

<b>Speed up to</b>	90 km/h
<b>Range up to</b>	1100 km
<b>Turning Radius (WB 4500 + 1450)</b>	9.9 m
<b>Gradeability up to</b>	60%
<b>Side Slope up to</b>	45%

## Protection (up to)

<b>Kinetic</b>	CEN B7 / STANAG 4569 Level 2
<b>Mine Blast</b>	STANAG 4569 Level 2a & 2b
<b>IED (side blast)</b>	20 kg TNT

## Special & Optional Features

- 2 or 4 Door Cabin
- Customized Internal Layouts
- Seating Capacity up to 6 Personnel
- 10.5 Ton HD Front Axle
- Front & Rear Tow Hook
- Tie Down Rings
- Rearview Camera
- Fitted for Radio 12V/24V
- Run Flat & Bead Lock System
- Automatic Fire Suppression Systems
- Roof Hatch
- Gun Ports
- Siren & Public Announcement System
- Hydraulic Recovery Winch
- Electro Hydraulic Tilting Cabin
- Single Tires or Twin Tires
- Super Single Tires on rear Axles
- Various Roof Rings
- Strobe Lights
- Camera & Recording System
- Spare Wheel Holder

## Vehicle Engine

Diesel engine with exhaust Turbo charger and Intercooler- Common rail direct injection. Water cooled, capable to operate in high ambient temperatures and desert environment.

<b>Engine Power up to</b>	480 HP
<b>Max. Torque up to</b>	2100 Nm
<b>Fuel Tank up to</b>	600 l

## Drivetrain

<b>Transmission</b>	Fully automatic with torque converter
<b>Transfer case</b>	High and Low range with center differential lock
<b>Axles</b>	Double reduction. 100% Locking Inter Axle and Differentials. High Mobility Leaf Spring Suspension
<b>Steering LHD &amp; RHD</b>	Heavy duty hydraulic power steering with auxiliary cylinder
<b>Brakes</b>	Two circuit full air brake system with ABS and EBL
<b>Electrical</b>	24V RFI & EMI protected
<b>Climate control</b>	Heavy Duty HVAC system
<b>Tire Inflation System</b>	STIS / CTIS



Versatile loading options



Hydraulic Tilting Cab

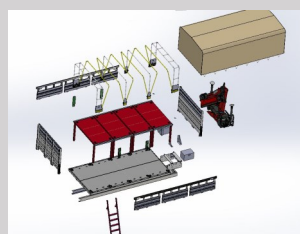

Fully customizable body systems/kits

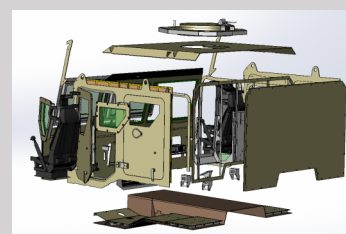

Cabin Kits SKD & CKD

**STEYR Trucks**  
**Sales and Services International GmbH**  
 Hohe-Linde-Strasse 1  
 A- 4595 Waldneukirchen  
 Austria  
 office@sti-steyr.com

**STEYR Trucks**  
**International FZE**  
 Al Hulaila Industrial Zone  
 Ras Al Khaimah  
 United Arab Emirates  
 www.sti-defense.com